



CHVNAV2

Installation Instructions

Select Chevrolet Vehicles

Please read this manual thoroughly before installation.

This manual shows a typical installation. Your vehicle may vary. Use caution and if unsure seek professional assistance.



Warning

Before head unit removing, make sure ACC power is off.

Cover all surfaces with tape or plastic protection film to protect against scratching and damage. Advent / Voxx is in no way responsible for any damage incurred during installation. This product has been validated in the vehicles listed on the application guide only. Consult Technical support at 800-323-4815 if you have any questions.



Components :

GPS Antenna



HDMI Cable



Video Output Flash Cable



Chevrolet T-Harnesses



VHB Tape



Video Input Cable



Interface Module



Suggested Installation Tools:



Screw Driver Components



Pry Tools



Towel

1: Using a nylon pry tool, carefully remove the trim bezzel covering the radio screen components.

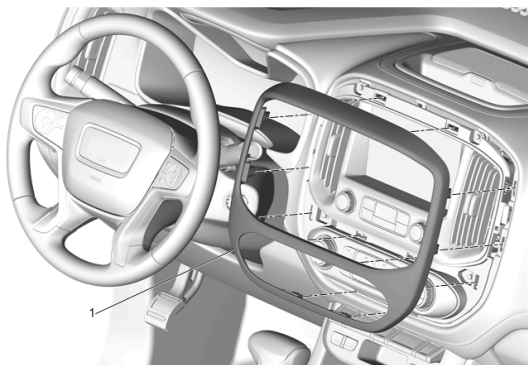

2: Remove the 4 screws shown and remove the controls and screen assembly.

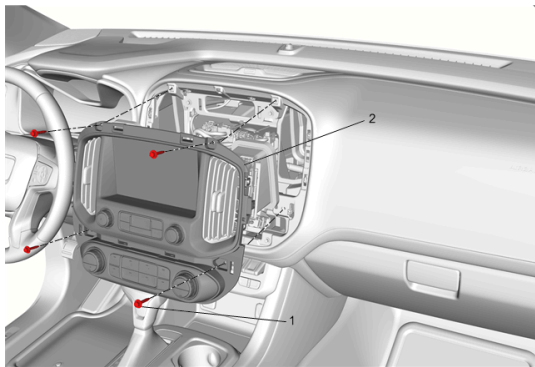

3: Remove the dash cover panel to access the factory speakers. If the vehicle does not have a center channel speaker you will use the front left dash speaker for Nav Audio. If equipped with a center speaker after dash panel removal, remove the center speaker cover to access that speaker.

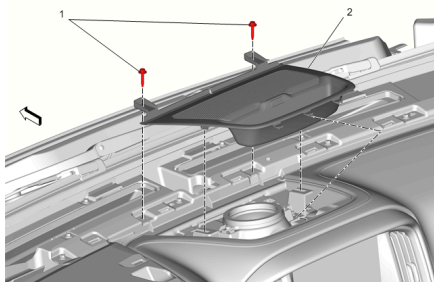
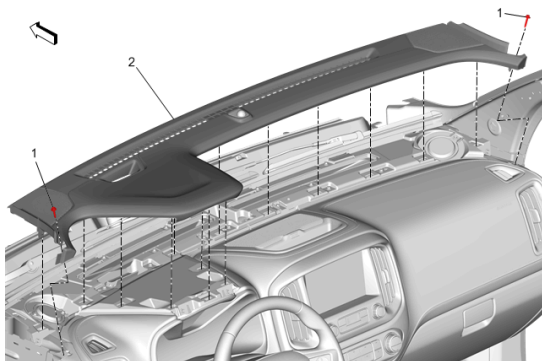

4: Disconnect the wiring from the Radio Module and remove from the dash by pressing down on the release hook and pulling toward you.

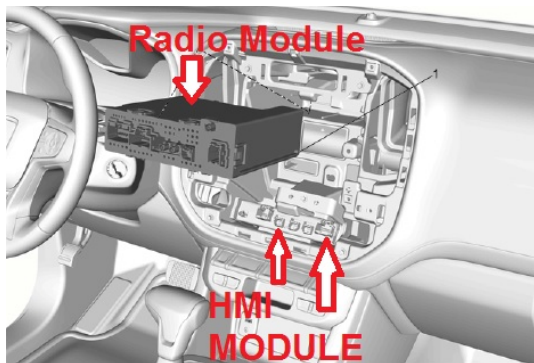

5: Route the speaker wire connection on the Nav interface harness up to the area below the dash cover. If there is a center speaker unplug the speaker connection and connect the speaker to the harness, then connect the speaker harness to the nav harness, this is a T-Harness and requires both connections. If no center channel speaker is present route the cable to the left front speaker and connect the same way.

6: Put the radio control module back into it's location.

7: Connect the Nav interface harness to the power connection of the radio and the radio power wire to the Nav Harness.

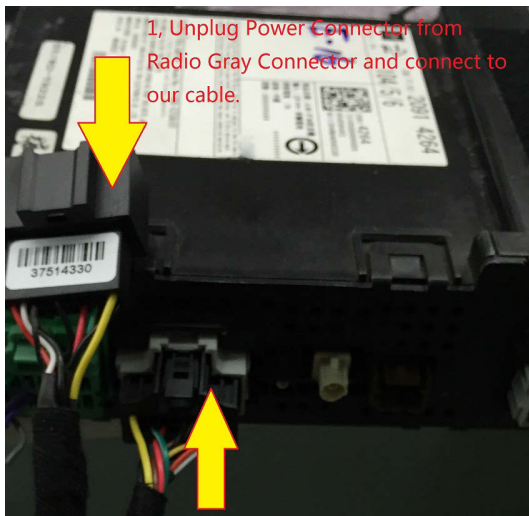

8: On the HMI module below, connect the Nav T-harness to the power connection as shown.

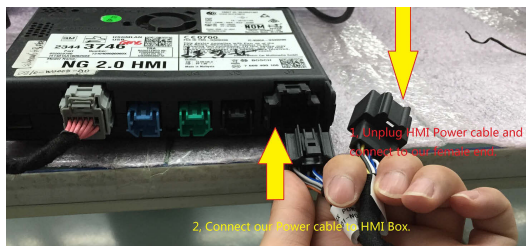

9: Disconnect the BLUE video connector on the HMI module and connect to the provided extension cable that will run to the Nav interface. Connect the provided Video cable from the HMI Blue port to the other port on the Nav interface, this completes Video in and out.

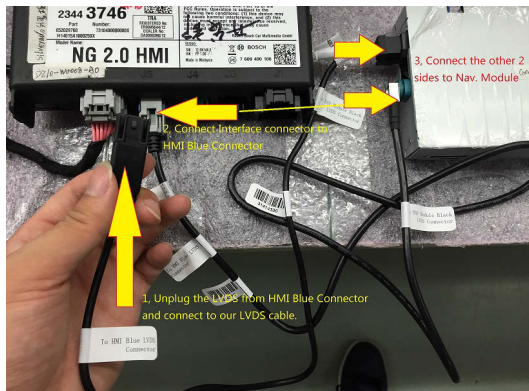

10: The Nav interface module will be located above the glove box or any other area that you have access to and can securely mount the module.

11: Route the wire harness white color connectors to the Nav Module final location.

12: Connect the white color connectors to the Nav module.



13: Mount the GPS antenna in a location that is not blocked by metal or glass containing a metallic coating, then connect to the blue antenna port on the nav module. If using a GMANTSP splitter, connect per it's instructions to the blue antenna port, this allows use of the factory on-star antenna. (Optional).

14: Connect and install the USB and HDMI cable connections in a location the customer can access to use these features. The USB connection is used for Map and System Updates, there is no reason for the customer to access the Nav module once it is installed. The USB will also charge a connected device but is not for media use. The HDMI connection will mirror HDMI compatible phones, note that most phones require an adapter to connect to an HDMI input. Contact the Phone provider or Carrier for an approved adapter.

15: Check all connections and then re-connect the vehicle battery. Test the system before replacing all dash panels.

The vehicle must be outdoors to obtain a GPS Location once powered on.

Wiring diagram

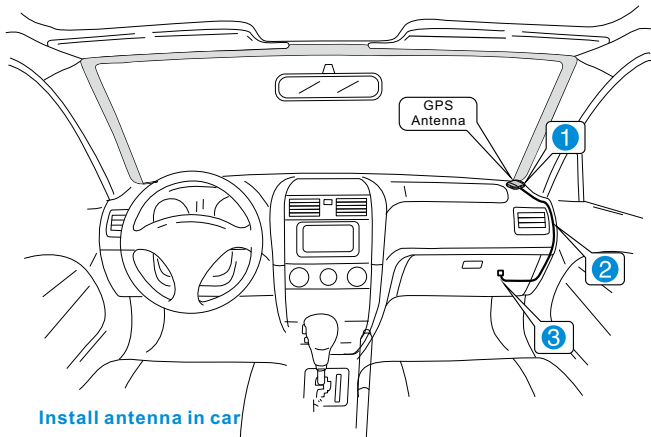

GPS antenna installation

1. Clean adhesion area with oil-soluble detergent, and fix GPS antenna with adhesive tape tight.
2. Remove the right cover of storage box, thread the cable from storage box to center console and tie up with OEM cable together.
3. Plug GPS antenna in head unit.

Notice:

Make sure all equipments are installed in secure place. If installed other automotive equipments, please be sure they are not interfering each other. Read all instructions before installation, and be recommended to install this unit by audio professional vendors.

Wiring diagram:

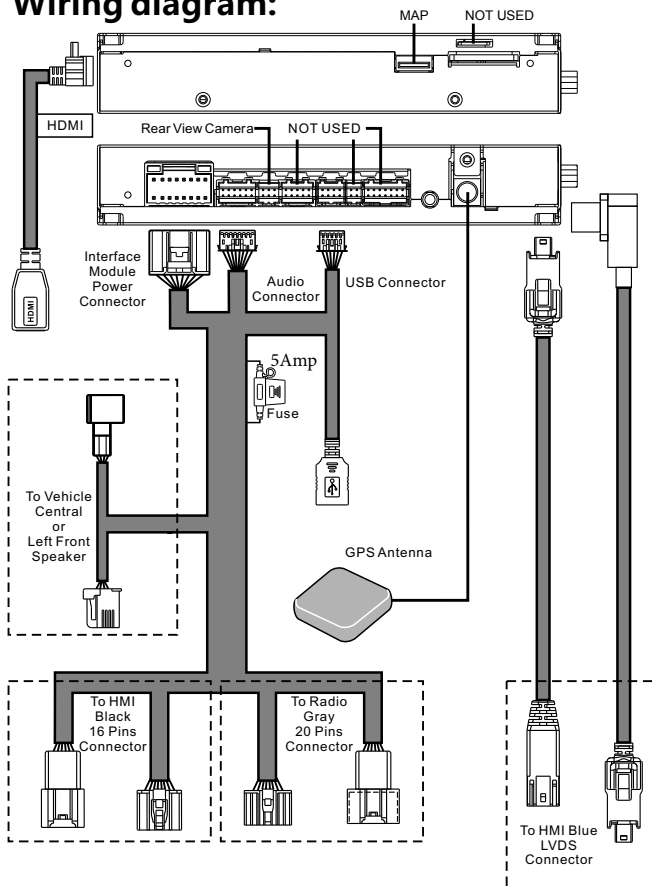

Prior to Installation:

Care must be taken when installing this accessory to ensure damage does not occur to the vehicle. The installation of this accessory should follow approved guidelines to ensure a quality installation. Read entire instructions thoroughly before starting.

This document covers such items as:-

- Vehicle Protection (use of covers and blankets, cleaning chemicals, etc.).
- Vehicle Disassembly/Reassembly (panel removal, part storage, etc.).
- Electrical Component Disassembly/Reassembly (battery disconnection, connector removal, etc.).

NOTES:

Removed Parts: Inspect the vehicle for any damage.

Place all removed parts on a protected surface in an area where they will not be damaged.

Connectors: When disconnecting connectors, do not pull on the wires; pull on the connectors.

Vehicle Preparation and Protection

Do not touch the positive terminal with any tool when removing

Be sure ignition key is in the OFF position during install. Do not disconnect ANY airbag connectors or indicators. Doing so may result in activating a diagnostic code. These codes will require the dealer to perform the reset procedure and may be charged a dealer fee. If you are unsure of any vehicle trim removal process consult the OEM service manual.

Removing vehicle trim panels in extreme hot and cold climate could result in some vehicle damage. Use care when removing all vehicle trim.

Using tape on vehicle trim panels could help limit any scratches and or marring. Use plastic trim panel removal tools whenever possible.

The instructions included in this kit are current at the time of printing. It is designed as a guide to help make the installation of this product successful. Always use caution and ask for assistance if you are not sure how to proceed. Voxx International is not responsible for any damage that may occur during installation or any changes to the vehicle interior.