

ADV2010

Rear Seat Entertainment System Owners Manual

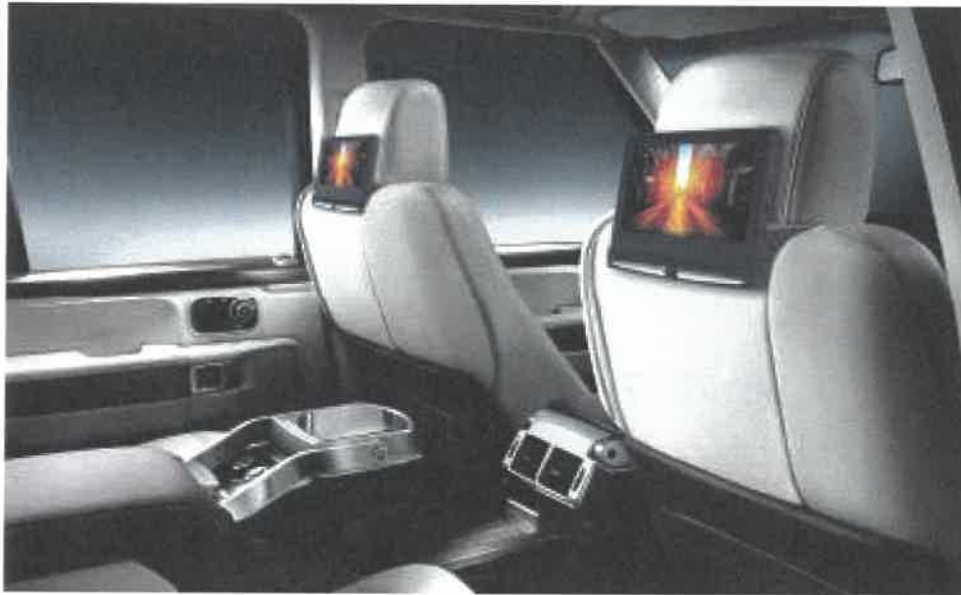

ADV2010 Owners Manual

English

© 2017 Voxx Electronics Corp.

All rights reserved. This manual, or any portion thereof may not be reproduced without the express written consent of Voxx Electronics Corp.

For any questions, please call or email customer service:

(800) 645-4994

www.support@voxxintl.zendesk.com

ADV2010 Owners Manual

Table of Contents

General Information	4
Safety Instructions	4
General Characteristics	4
Cleaning and Care	4
Supported Media	5
Country Codes	5
Front Panel Control Buttons	6
Inputs/Outputs	7
Remote Control	8-9
Wireless IR Headphones	10
How to Identify Monitor A/B	10

Operation

Playing a DVD or CD	11
Wireless Playback of Media (Miracast/DLNA)	11
Playing Media via AUX Input	11
Playing Media via USB Input	11
Playing Media via HDMI/MHL Input	11
FM Transmitter Function	11
Sharing Media between Monitors	12

Setup

Main Menu	13
Troubleshooting	14
Compliance Information	14-16
Specifications	16

General Information

Please read this instruction manual carefully.

Poor road conditions can cause problems with some media playback.

In cold environments, the screen may sometimes display distortion. This is normal.

Safety Information

For safety reasons, it is recommended that media is only changed when the vehicle is not in motion. Children should not be permitted to unfasten their seatbelt to function the system or change media. The system can be controlled using the remote control while seatbelts are fastened.

The use of headphones at high volume can cause permanent damage to hearing. To avoid hearing damage, set the volume to low before using them.

It is unlawful, in most jurisdictions, and unsafe to drive a motor vehicle which is equipped with a video display that is visible, directly or indirectly, by the driver while moving. This system should never be installed where visible by the driver.

Cleaning and Care

Clean your rear seat entertainment system with a soft, dry cloth. For stubborn deposits, a mild cleaning agent may be used. Wipe off and finish with a dry cloth.

Please note that strong cleaning agents, such as alcohol, thinners, benzene, insecticides, may cause damage to the system and should never be used.

General Characteristics

- 10.1" Digital LED Backlit LCD Display
- 1024 x 600 Resolution
- Slot load DVD Player
- USB 2.0 Reader /2 amp charging
- Miracast/DLNA (wireless connection to Smart Phones)
- Front Capacitive Touch Controls
- Supports Dual Channel IR Headphones
- IR Remote Control
- Analog A/V input (1/8" Jack)
- Full Band FM Transmitter
- Wired Headphone Output (1/8" Jack)

Caution!!!

Do not operate the system without the vehicle running, as it may cause the battery to drain. Please make sure the system is turned off when the vehicle is not running.

Warning!!!

Some vehicles come equipped with an energy efficiency mode that shuts down the vehicle when stopped for a prolonged period of time, such as a stop light, and then turns the vehicle back on what the brake pedal is released. These vehicles also operate at a reduced voltage when this feature engages. It is suggested to turn off the vehicles energy efficiency mode if using the ADV2010 system to prevent the system from powering down when the energy efficiency mode engages.



Supported Media

Supported disc media

Before inserting media, ensure that it is compatible with the system. Please note that the following data media is NOT compatible with the system:

- Optical Data Media (CD-1, CD-ROM, DVD-ROM)
- Mini Disc

Compatible Disc Types

Symbol	Disc Type
	Video DVD
	Audio CD (ie: CD-R with MP3, MPEG, WMA, or JPG files)
	Video CD

Country Code Restrictions

If the country code on a DVD disc does not match the system country code, the DVD cannot be played.

Region	Countries in this Region
1	Canada, USA, US territories
2	Japan, Europe, South Africa, Middle East (including Egypt)
3	South East Asia, East Asia (including Hong Kong)
4	Australia, New Zealand, Pacific Islands, Central America, Mexico, South America, Carribean
5	Former Soviet Union, (also North Korea, Mongolia), Indian subcontinent, Africa
6	China

English

Supported USB media files

MP3,WMA,OGG,MPE,MPG,MPEG,AVI, DIV,VID,VOB,JPG,JPEG, AAC, M1V, M2V, OGM.

Supported HDMI/MHL input

- HDMI media from any HDMI output device (ie: Smart Phone, SmartTV Sticks - ROKU, Chromecast, FireTV).

- HDMI media from MHL compatible device (ie: MHL compatible Smartphone, SmartTV Sticks).

NOTE: Only certain devices are HDMI/MHL compatible and may require special cables and/or adapters (please check with your device manufacturer).

Panel Control Buttons/Disc slot

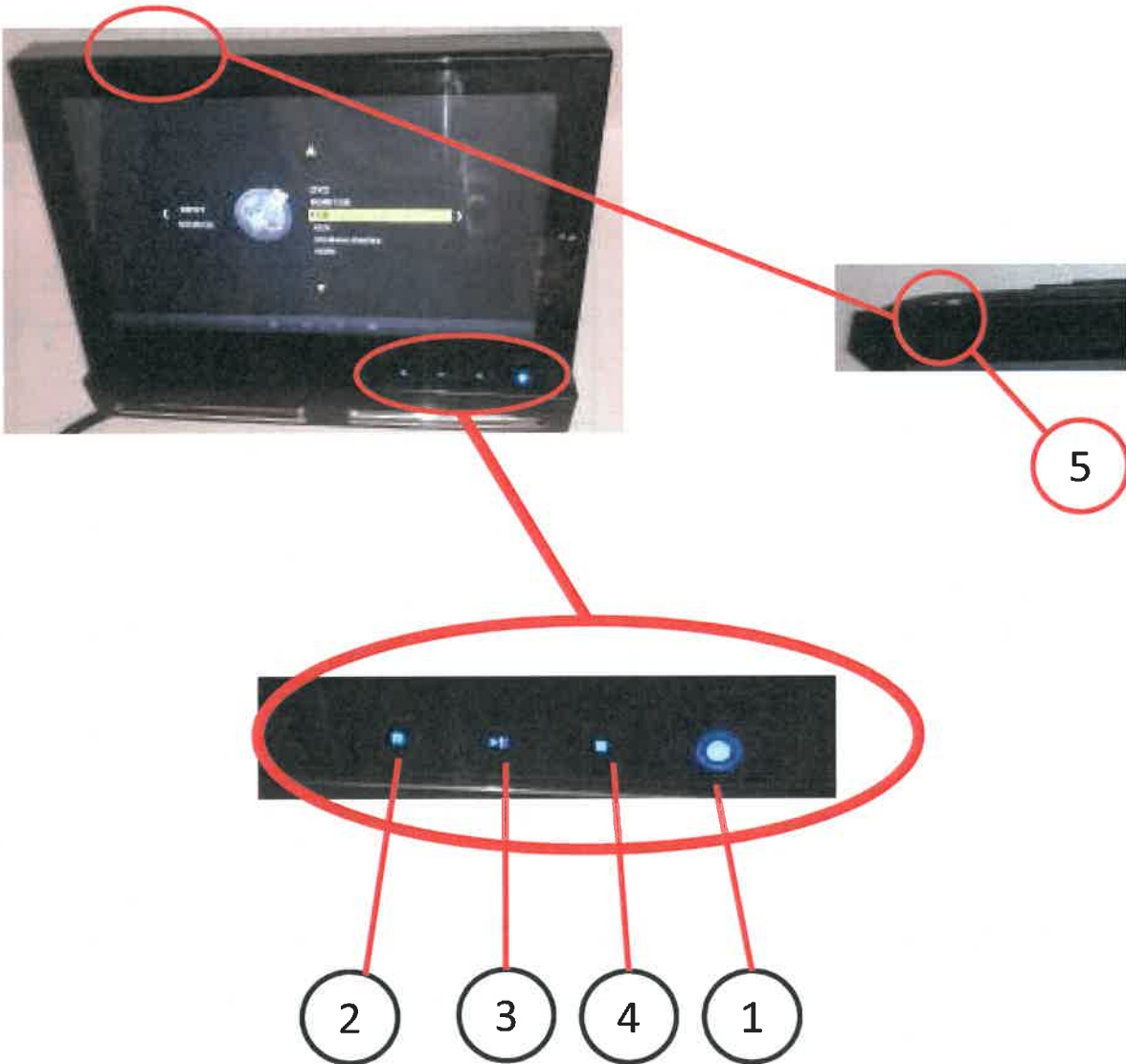

1. Power Button - Turns system power On/Off
2. Source Button - Select media source for playing media (ie: DVD, AV Input, MHL/HDMI, Wireless Screen Mirroring, USB)
3. Play/Pause - Starts/Pauses Media source selected
4. Stop - Stops media that is playing
5. Eject - Ejects disc

Inputs/Outputs



1. Disc Slot
2. HDMI Input (MHL compatible)
3. USB 2.0 input (2 amp charging)
4. A/V Input (1/8" Jack)
5. Headphone Output (1/8" Jack)

Remote Control Buttons/Functions

To control monitor A, press the A button first. To control monitor B, press the B button first.

(SEE WIRELESS HEADPHONE DETAIL PAGE FOR MORE INFO)

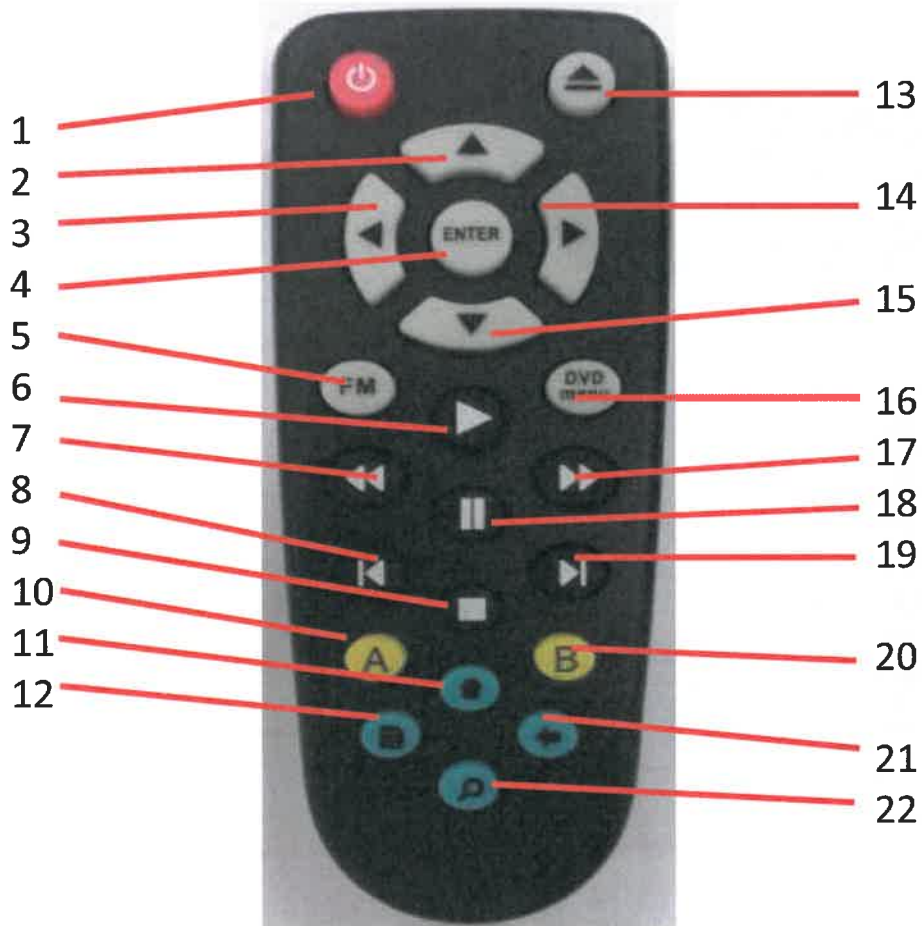

1. **POWER** - Turns power on/off
2. **UP** - Navigate selection up
3. **LEFT** - Navigate selection left
4. **ENTER** - Accept selection
5. **FM** - Turns FM transmitter on/off (station can also be changed when button is depressed) **Function is for Monitor A only.
6. **PLAY** - Select to play media
7. **REVERSE** - Fast reverse playback
8. **PREVIOUS** - Selects previous track
9. **STOP** - Stops media from playing
10. **A** - Depress to control A monitor
11. **HOME** - Back to home page
12. **MENU** - Selects Menu Screen

13. **EJECT** - Ejects disc
14. **RIGHT** - Navigate selection right
15. **DOWN** - Navigate selection down
16. **DVD MENU** - Displays DVD "ROOT MENU"
17. **FORWARD** - Fast forward playback
18. **PAUSE** - Pauses media being played
19. **NEXT** - Selects next track
20. **B** - Depress to control B monitor
21. **BACK** - Back to previous page
22. **SEARCH** - Selects search

Remote Control Battery Installation/Operation



1. Remove battery cover by depressing tab (in direction of arrow) then lifting cover.
2. Insert 2 AAA batteries (make sure batteries are installed with correct polarity (+/-))
3. Reinstall battery cover

! NOTE: There is risk of fire if batteries are not installed correctly. Do NOT recharge batteries. Do NOT intermix different battery types, or batteries with different charge capacity. Please dispose of batteries per local laws. **Please keep batteries out of the reach of children.**

Operation

To control monitor A, press the A button first. To control monitor B, press the B button first (**SEE HEADPHONE DETAIL PAGE FOR MORE INFO**) The remote control has an infrared beam which must be aimed towards the lower area of the display monitor being controlled.

The monitor will not receive remote signal if beam is blocked.

Wireless Headphones

The supplied Wireless Headphones are Infrared dual channel (A and B channel)

The correct channel must be selected to match the display monitor being viewed (see below)

Headphones must have unobstructed line of sight to the display monitor to receive audio signals

Headphones require (2) AAA batteries.

Caution: Please make sure volume control is set to low for the safety of users (excessive volume can cause permanent damage)

Note: Headphones will power off automatically if no audio is present for more than 3 minutes. This is to prevent unnecessary battery drain. Press the power button to turn the headphones back on.



Volume control
Power on/off switch
Channel A/B selection switch
Battery cover (depress and slide down to remove)

Monitor "A/B" identification location

Follow menu sequence below:
Audio>IR transmitter (Monitor "A"
or "B" will be shown)

**NOTE: BE CAREFUL, AS MONITOR
CAN BE CHANGED IN THIS MENU
IF MONITOR IS SELECTED**

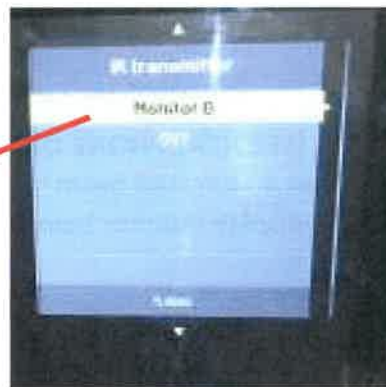

Operating Instructions

Turning power on

Turn vehicle ignition "ON/ACC".
Press the power button on the monitors front panel or on the remote control.

Playing a Disc

Insert a disc (label side facing towards you).
Make sure DVD is the selected source.
Press play to start media playback.

Playing media from USB

Insert USB device into USB slot on the right side of the unit.
Make sure USB is the selected source. Use navigation buttons on remote to select media files.

Playing media from AUX input

Plug the male end of AV cable into the 1/8" AV input on the right side of the unit. Plug the other end (RCA type) into the source device.
Make sure AUX is the selected source. Play device per device instructions.

Playing media from Wireless Display (Screen Mirroring from Smartphone, etc)

Select "Wireless Display" from source menu.
Follow screen mirroring instructions on smartphone/tablet to play media. Please note that wireless content playback may be restricted depending on the type of Smart Device you use and the application you use to access content. Limited wireless playback does not indicate a unit failure mode.

Playing media from HDMI/MHL input

Plug a SmartTV stick or an HDMI cable into the HDMI jack on right side of unit.
If using an HDMI cable, plug the other end of cable into the content source device.
Make sure MHL/HDMI is the selected source.
Play device per device instructions.

NOTE 1: Only devices with MHL or HDMI output capability can be used. Connecting a Smart Phone may require an HDMI adapter specific to your Smart Phone (sold at most electronic retailers).

Playing audio through vehicle radio system (only plays from Monitor A)

Press FM on the remote control (if FM button is depressed again, it will turn off the FM transmitter)
Use the left/right navigation buttons to select desired radio station to play audio (88.5MHZ ~ 107.5MHZ)
Tune vehicle radio to station selected on unit.
NOTE: Quality of audio may be affected by the station selected. It is best to select a station where no broadcast is present.

Sharing media from monitor A to monitor B

Make sure media is playing on monitor A, then follow the menu sequence below on monitor B:

Input source>Monitor

Monitor B will display whatever is playing on monitor A

Sharing media from monitor B to monitor A

Make sure media is playing on monitor B, then follow menu sequence below on monitor A:

Input source>Monitor



Main Menu

Below are all the main menus. Menus can be found by selecting the "source" button, on remote, then use the left/right navigation buttons to locate desired menu.



Input source Menu (default home page)

Contains list of sources for playing media (note: wireless display may be optional)

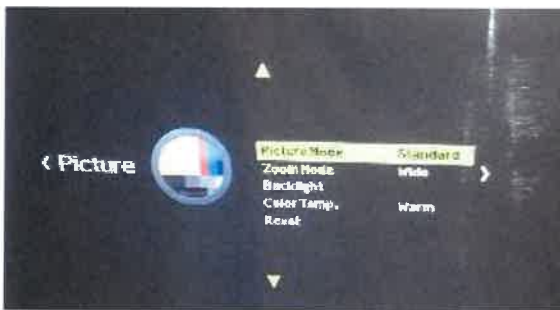

Picture Menu

Contains list of controls for picture settings

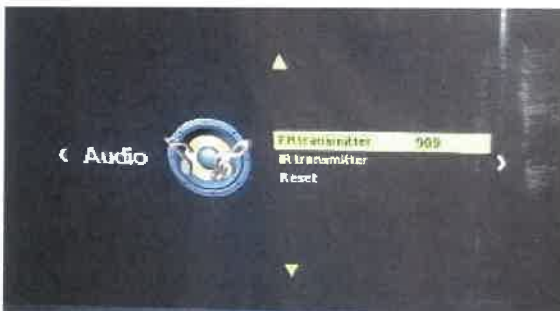

Audio Menu

Contains list of controls for audio settings, including FM Transmitter (to play audio through vehicle FM radio)

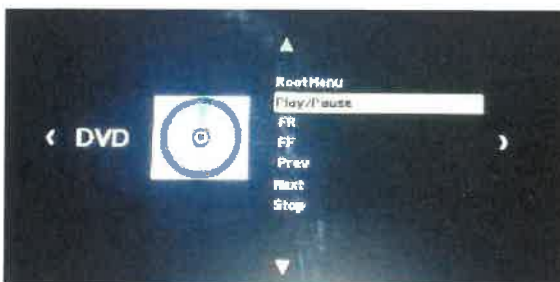

DVD Menu

Contains list of controls for disc player (note: disc must be inserted for menu to appear)

Troubleshooting

Unit will not power on

1. Be sure vehicle ignition is in the on position.

Remote control not working

1. Check batteries for correct installation and make sure they have plenty of charge left.
2. Make sure correct monitor is selected on the remote for the monitor desired to be controlled (monitor A/B)
3. Be sure remote is aimed directly towards top of monitor being controlled with no obstructions.

No picture

1. Ensure correct source is selected (ie: DVD, USB, etc)
2. Ensure any external devices are correctly connected (ie: cable/s for AUX input , USB, etc)

No sound through IR headphones

1. Check batteries for correct installation and make sure they have plenty of charge left.
2. Check to make sure the channel selected on headphones matches the monitor being watched (A or B). See headphone instruction page for more details.
3. Be sure headphones are in line of sight of display monitor being watched with no obstructions.

Sharing inop (can't select monitor on menu)

1. Check cables for proper connections.
2. Be sure monitors are both powered on and have media playing

FCC declaration

This system complies with FCC directive, section 15. System is subject to the following 2 conditions:

1. This system must not cause any harmful interference
2. This system may be subject to interference which may cause unwanted operation.

FCC warning

1. In order to ensure ongoing FCC compliance, the system must be connected and operated with the supplied cables only.
2. Unauthorized modifications or alterations to the system may void this operating permit.

FCC notice

Notice : The changes or modifications not expressly approved by the party responsible for compliance could void the user's authority to operate the equipment.

To comply with the FCC RF exposure compliance requirements, no change to the antenna or the device is permitted. Any change to the antenna or the device could result in the device exceeding the RF exposure requirements and void user's authority to operate the device.



Canada IC

This Class B digital apparatus complies with Canadian ICES-003.

This device complies with Industry Canada license-exempt RSS standard(s). Operation is subject to the following two conditions: (1) this device may not cause interference, and (2) this device must accept any interference, including interference that may cause undesired operation of the device.

This device and its antenna(s) must not be co-located or operation in conjunction with any other antenna or transmitter.

Under Industry Canada regulations, this radio transmitter may only operate using an antenna of a type and maximum (or lesser) gain approved for the transmitter by Industry Canada. To reduce potential radio interference to other users, the antenna type and its gain should be so chosen that the equivalent isotropically radiated power (e.i.r.p.) is not more than that necessary for successful communication.

Macrovision

This product contains copy protection technology protected by US patents and other intellectual property rights. The use of this copy protection technology requires the permission of macrovision and is intended without express further approval from macrovision only for domestic use and other limited applications. Reverse engineering or dismantling are forbidden.

Specifications

Panel size	10.1"
Resolution	1024 x 600
Backlight	LED
Ratio	16:9
Luminance	500 NIT (typ.)
Expected backlight life	20k hours Min.
Operation temperature	-20~70 degrees C
Storage temperature	-30~80 degrees C
Video display system	NTSC
Input voltage	10-16VDC
I/O ports	USB 2.0, HDMI, 3.5mm AV, 3.5mm earphone
IR Channels	A monitor: 2.3/2.8mhz B monitor: 3.2/3.8mhz
Supported formats	MP3,WMA,OGG,MPE,MPG,MPEG,AVI, DIV,VID,VOB,JPG,JPEG AAC, M1V, M2V,OGM

WEEE directive

Disposal of old electrical and electronic equipment (applicable in the European Union and other European countries with separate collection systems)



This symbol on the product or its packaging indicates that the device must not be treated as household waste. Instead, it must be handed over at the relevant collection point for the recycling of old electrical and electronic equipment. With correct disposal of the device, you are helping to avoid any negative effects on the environment and human health which might otherwise be caused by the incorrect disposal and treatment of waste. The recycling of materials helps preserve natural resources. You can obtain more information about recycling this device from your city council, your disposal company for household waste, or from the store in which you bought it. Applicable accessories: remote control, headphones.